

REV.	ECN	DESCRIPTION	MDF'D	DATE
A		初版	HARRY	2019.06.29

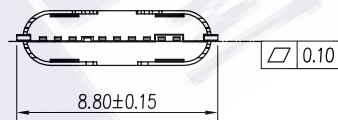

Specification:

- Electrical Characteristics:
 - Contact Current Rating: 3 Amperes Max.
 - Rated Voltage: 30V Max.
 - Dielectric Withstanding Voltage: AC 100V r.m.s.
 - Insulation Resistance: 100 MΩ Minimum.
 - Contact Resistance: 40 mΩ Maximum.
- Environmental:
 - Operating Temperature: -30°C~+85°C.
- Mechanical Characteristics:
 - Insertion Force: 20N max.
 - Withdrawal Force: 5~20N.
 - Durability Cycles: 10000 Cycles.

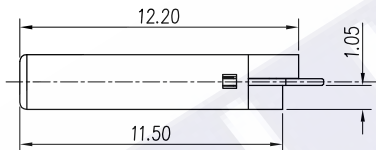
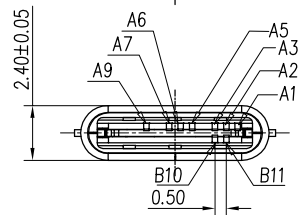
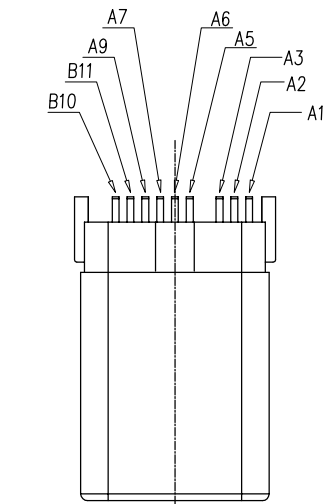
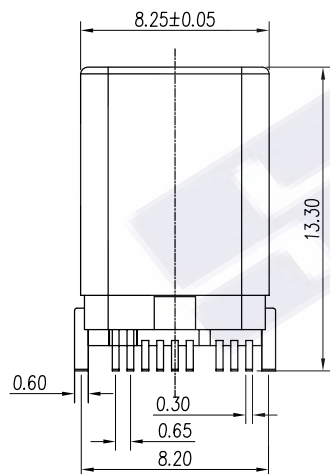

5	EMC SPRING	Stainless Steel; T=0.10mm;
4	CONTACT	Copper Alloy; Au1u"
3	LATCH	Stainless Steel; T=0.3mm;
2	HOUSING	LCP Thermoplastic, UL94V-0;
1	SHELL	Stainless Steel; T=0.15mm;
NO.	NAME	DESCRIPTION

A12	A11	A10	A9	A8	A7	A6	A5		A3	A2	A1
			VBUS		D-	D+	CC		TX1-	TX1+	GND
									RX1-	RX1+	
B1	B2	B3	B4	B5	B6	B7	B8	B9	B10	B11	B12

三佐部品【中国】股份有限公司

X. ±0.25	X.* ±5°	??	mm	品名	9P 单排SMT 拉伸款无插板脚, 卡勾加长			制图	HARRY
.X ±0.20	.X* ±3°	??	⊕	规格	MTKKP09WT1AWLNG1N			设计	
.XX ±0.15	.XX* ±1°	??	1:1	??	1/1	??	B.TC.2.M.090A	??	
.XXX ±0.10	.XXX*	??	A	??		??	穴数	??	G.Q.L